

collectiv

WE ARE
COLLECTIV

 **nuova
SIMONELLI®**

AURELIA WAVE T3 2 GROUP

The global espresso standard. The future of espresso extraction. This advanced technology is encased in the highest quality materials, built by Nuova Simonelli's expert team in Italy, making it as reliable as it is versatile.

KEY STATISTICS

Number of groups: 2 **Power (watts):** 6600 **Boiler Size (litres):** 14

Product Code: 10104



COLLABORATIVE. COMMITTED. COMMERCIAL.

The global espresso standard. The future of espresso extraction.

- Managed coffee profiles – the Wave introduces Pulse-Jet, the latest Simonelli technology that optimises flow rate and water pressure during dispensing. The result is a range of aromas, tastes and extraction profiles to enhance your coffee.
- T3 Technology temperature control – World Barista Championship approved T3 Technology was developed by Simonelli, with the support of university research and work with the world's leading Baristas. It allows for complete ownership of the temperature at each delivery phase, giving experienced baristas the freedom to adapt the Aurelia's capabilities to extract desired flavour profiles.
- Adaptability meets reliability – with controllable parameters, you can adapt the Aurelia Wave around your needs. Thanks to the innovative TFT graphic display with rotary control, making precise changes is easier than ever. This advanced technology is encased in the highest quality materials, built by Nuova Simonelli's expert team in Italy, making it as reliable as it is versatile.
- Key features – ergonomic design, eco-sustainability, automatic cleaning, built-in volumetric dosing, remote control interface, pre-set extraction settings, auto-purge, cool touch push and pull steam wand and touch screen display.

SPECIFICATIONS

Water connection	1-5 BAR isolated 15mm feed, 3/4" BSP screw fitting
Filter type	Brita Purity 600/1200 C50
Waste	1.5" downpipe to P-trap, minimum length 8"
Power (watts)	6600
Boiler size (litres)	14
Power requirements	1 x 230Vac 32A single phase commando socket Optional - must be specified when ordered 1 x 415Vac three phase commando socket 16A per phase
Breaker	C
Weight (kg)	102
Dimensions w x d x h (mm)	802 x 605 x 537



605mm



802mm

537mm

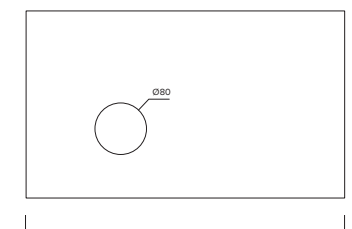

802mm

Hole is required through the counter

RECOMMENDED PRODUCTS

nuova SIMONELLI®

MYTHOS ONE GRINDER

Product Code: 8425

COFFEEWORKS BARISTA PACK

Product Code: SERUCC0300

